

FORM NO 1.

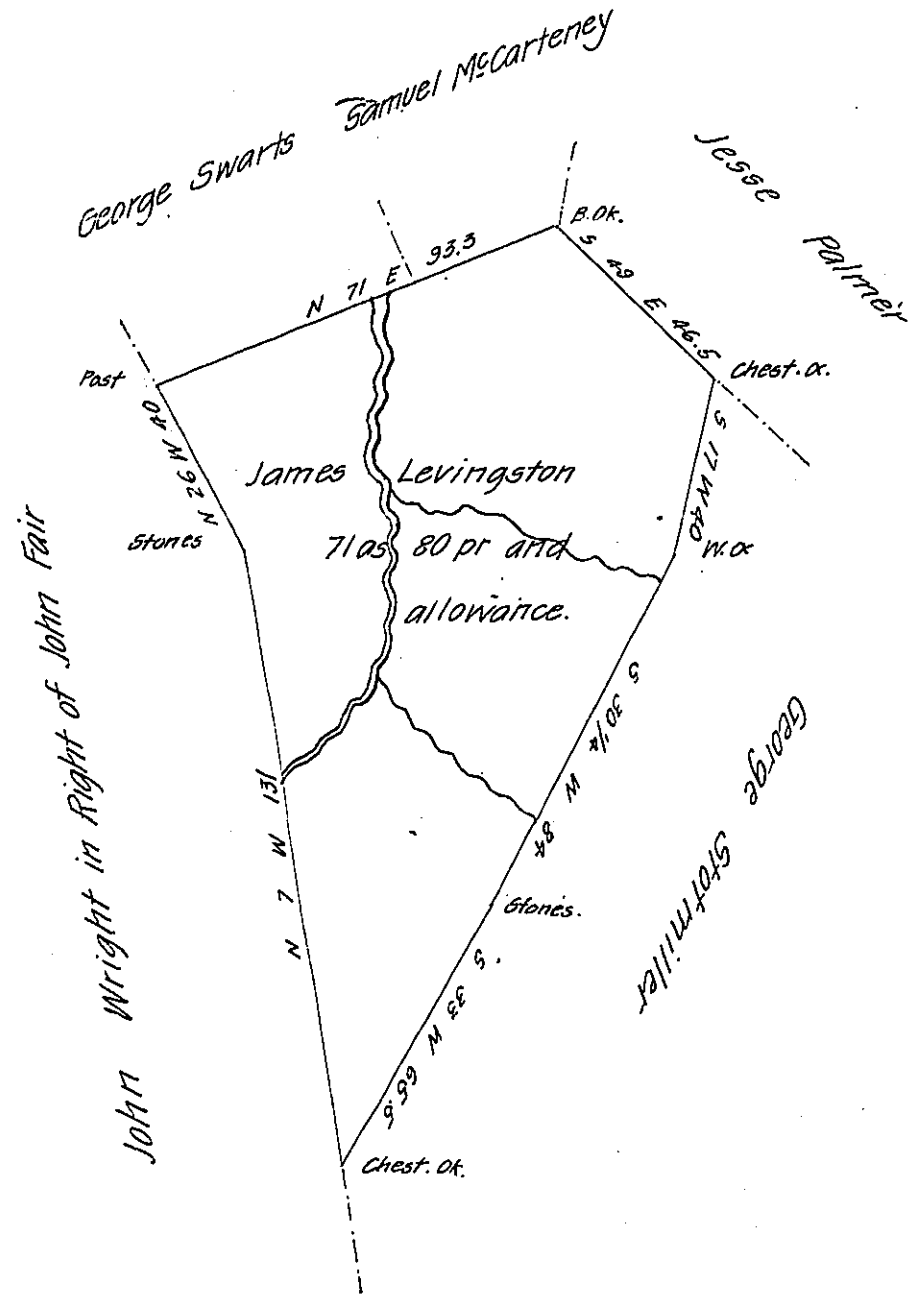

C. 1. 293

Surveyed on the 4th day of December A.D. 1862 to James Levingston the above described tract of land including an improvement containing Seventy one acres and Eighty perches and the usual allowance of six per Cent for Roads &c. Situate adjoining lands of John Wright in right of John Fair, George Swarts, Samuel McCartney Jesse Palmer and George Stottmiller in Burrel township Indiana County By warrant of the 11th of September A.D. 1862

Wm. Evans County Surveyor

To Henry Souther Esqr.

for Indiana County

Surveyor General

N.B. The above Survey was made and returned at the request of Charles Casady who is now in the actual possession of and has a deed of Conveyance from James Levingston (the warrantee) and wife for the same

Wm. Evans C.S.

IN TESTIMONY that the above is a copy of the original remaining on file in the Department of Internal Affairs of Pennsylvania, made conformably to an Act of Assembly approved the 16th day of February, 1833, I have hereunto set my Hand and caused the Seal of said Department to be affixed at Harrisburg, this twenty ninth day of January 1908

Henry Howe
Secretary of Internal Affairs.